

How to Sign in with an existing Apostrophy account with the MCo2

How to Sign in with an existing Apostrophy account with the MCo2

1. Ensure you have an internet connection (SIM data or WLAN).
2. You must complete all of the steps in order to sync with Apostrophy Calendar and Contacts.
3. Open 'My Account' app on the home screen if skipped during the first time set up.
4. If you already have an Apostrophy account, Sign in by entering your aphy.io email address and password.
5. Tap 'SIGN IN'.
6. Tap 'SYNC ACCOUNT', at the bottom right hand side of screen.
7. Tap 'LOGIN' at the bottom right hand side of screen.
8. Tap 'CREATE ACCOUNT' at the bottom right hand side of screen.
9. Your account is ready to go.

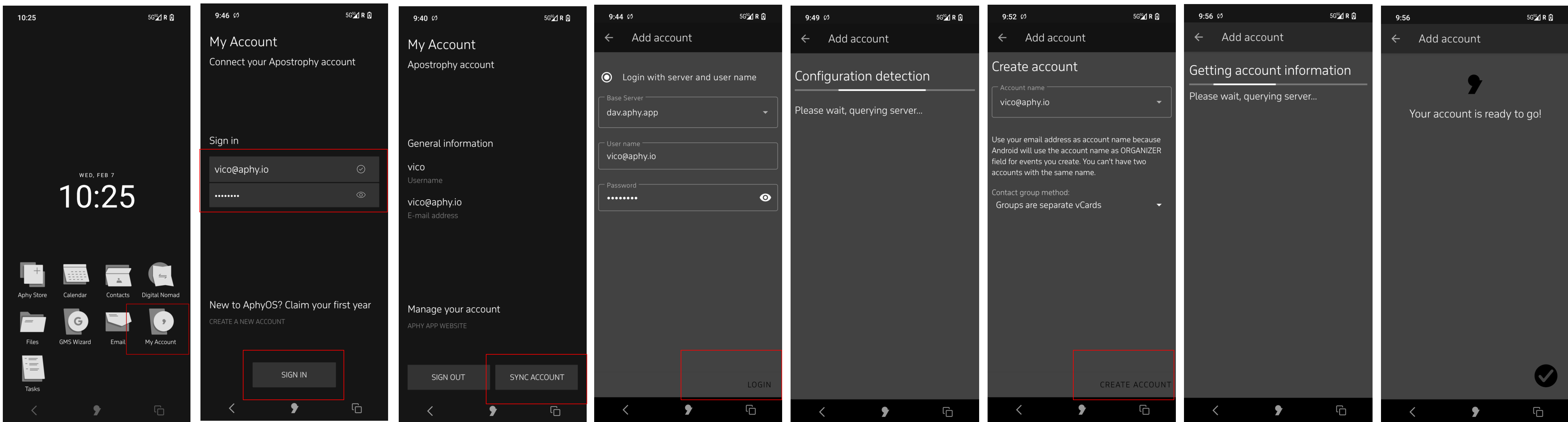

Error messages

1. No internet connection
“No Network connection”

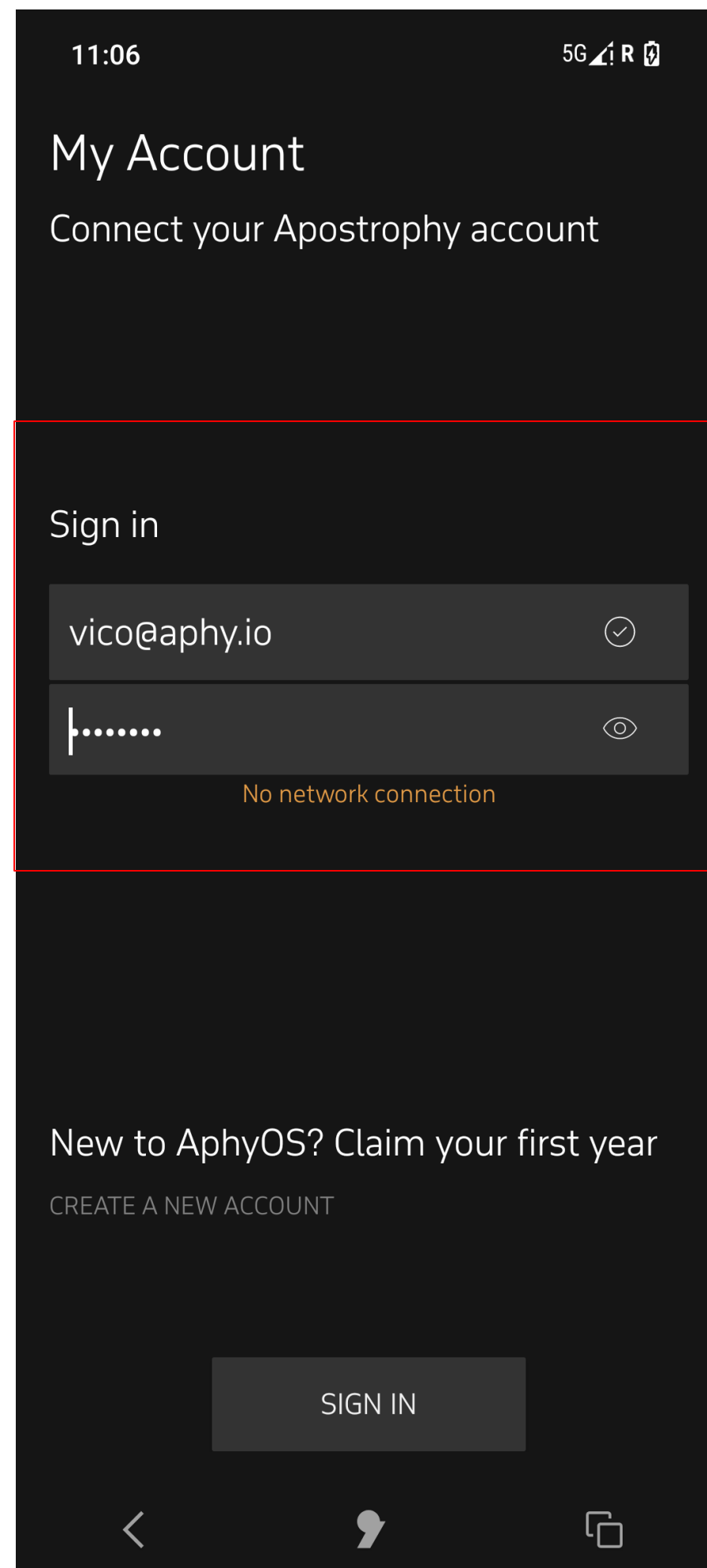

2. If during sign in, an incorrect email or password is entered.
“Connection failed. Please check account info”.

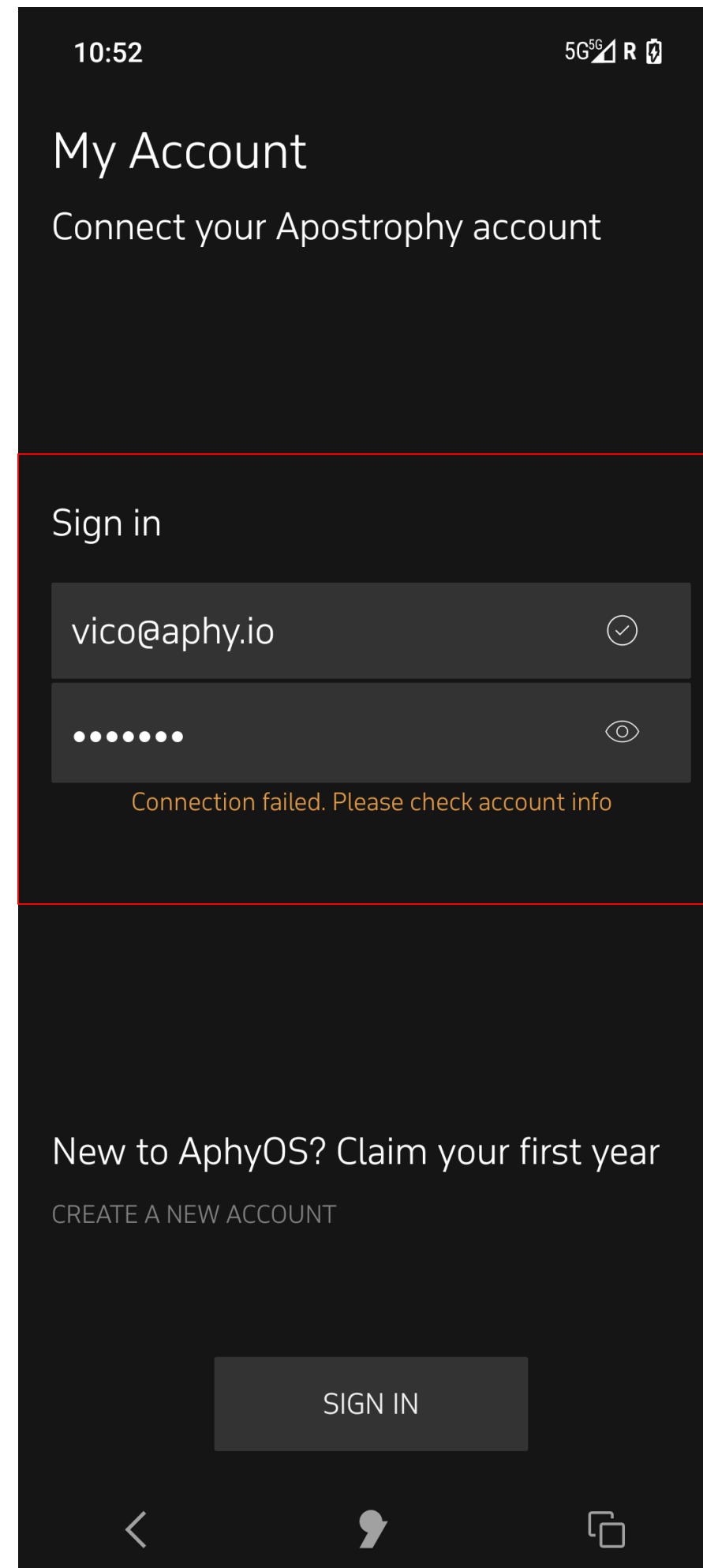

punkt.ch
info@punkt.ch

Tel +41 91 924 9003
Fax +41 91 924 9004

Punkt Tronics AG
Via Losanna 4
CH-6901 Lugano
Switzerland

Punkt.